

# KEY PLAN

Scale - 1:350

CLEARANCES FOR BUSBARS AND CONNECTIONS IN ACCORDANCE WITH WPD SAFETY RULES AND BS EN 61936-1:2010

1	VOLTAGE BETWEEN PHASES	132kV
2	MINIMUM CLEARANCE BETWEEN LIVE METAL AND EARTH	1300mm
3	MINIMUM CLEARANCE BETWEEN LIVE METAL OF DIFFERENT PHASES	1300mm
4	MINIMUM TOTAL AIR GAP BETWEEN TERMINALS OF THE SAME POLE OF ISOLATORS	1400mm
5	GAP BETWEEN LIVE AND EARTHED ARCING HORNS OR RINGS	990mm
6	MINIMUM SAFETY CLEARANCE (VERTICAL) BETWEEN LIVE METAL AND POSITIONS TO WHICH ACCESS IS PERMISSIBLE WITH OTHER EQUIPMENT LIVE	3500mm
7	MINIMUM SAFETY CLEARANCE (HORIZONTAL) BETWEEN LIVE METAL AND POSITIONS TO WHICH ACCESS IS PERMISSIBLE WITH OTHER EQUIPMENT LIVE	2900mm
8	MINIMUM CLEARANCE BETWEEN ANY SUBSTATION EQUIPMENT AND THE SUBSTATION FENCE	2000mm
9	MINIMUM INSULATION HEIGHT (PEDESTRIAN CLEARANCE)	2550mm

1. THIS DRAWING TO BE READ IN CONJUNCTION WITH ALL RELEVANT ENGINEERS AND SPECIALISTS DRAWINGS & SPECIFICATIONS.
2. ANY DISCREPANCIES BETWEEN THIS DRAWING AND ANY OTHER TO BE REPORTED TO THE ENGINEER IMMEDIATELY.
3. ALL WORKS TO COMPLY WITH THE MOST CURRENT BRITISH STANDARDS.
4. ALL DIMENSIONS IN MILLIMETERS UNLESS STATED OTHERWISE. USE FIGURED DIMENSIONS ONLY.
5. ALL DIMENSIONS TO BE  $\pm 3\text{mm}$  UNLESS SPECIFIED OTHERWISE.
6. A RECESSIVE COLOUR SUCH AS GREY IS PROPOSED, BUT CAN BE AGREED WITH OFFICERS.

## LEGEND:

- NEW DNO EQUIPMENT
- NEW CUSTOMER EQUIPMENT
- NEW FOUNDATIONS
- LC LC LIGHTING COLUMN - 3m MID HINGED

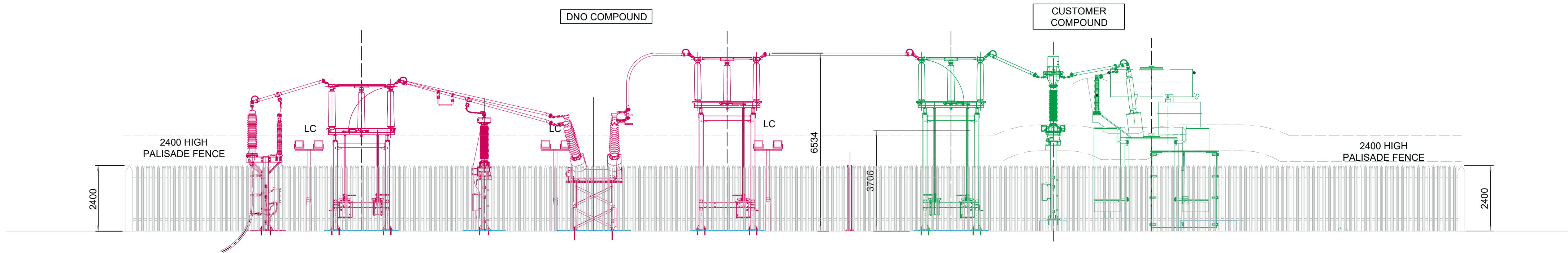

ELEVATION 'G'

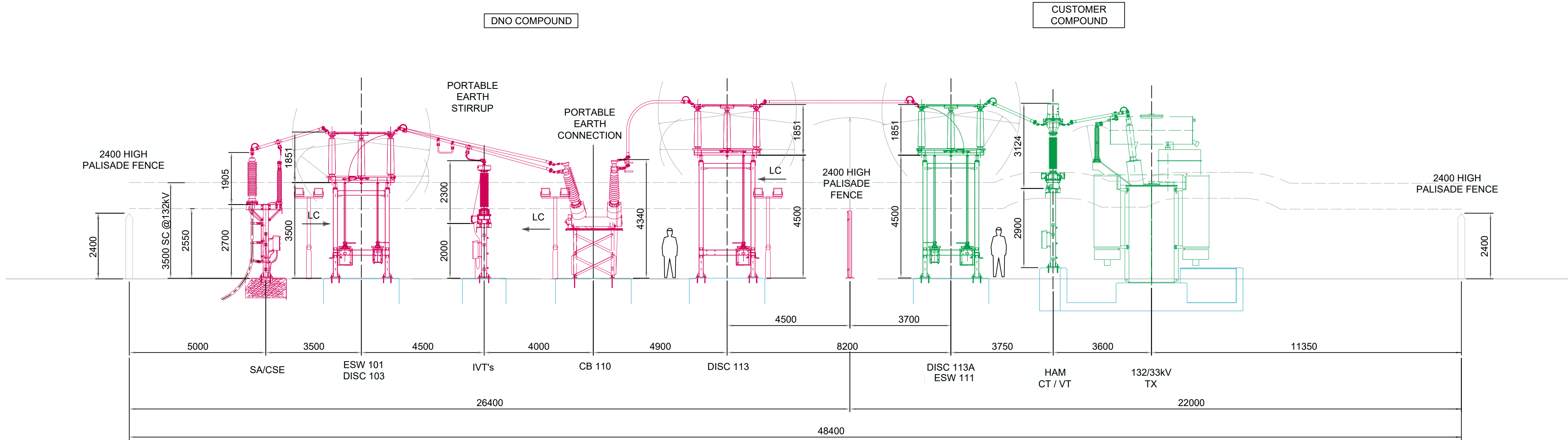

SECTION 'H'-H'

Scale - 1:100

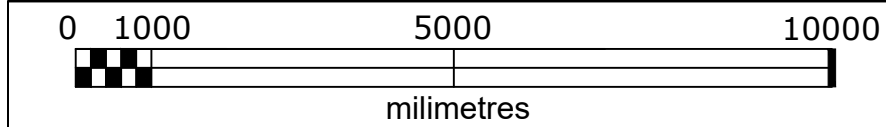

Project: Newfields Farm BESS

Drawing name: Elevations and Sections of 132kV Metering Substation

88-10-05-PL-SS-ELV-03

REN

R.05

Acoustic Fence Removed

19.02.2025

R.04

Acoustic Fence Added

12.04.2024

R.03

Text Related to Scaling Modified

19.01.2024

R.02

Sections Modified

13.03.2023

R.01

Scale Bar Added

05.10.2022

R.00

First Issue

21.03.2022

Revision

Description

Date

Discipline: Electrical

Phase: FOR PLANNING

Format: A1

Scale: 1:100

Sheet No: 03 / 03

Client: RE Project Development Limited

RENERGY LTD

28 E Samkov str.

1113 Sofia, Bulgaria

info@renergy-bg.com

www.renergy-bg.com

This drawing may not be reproduced or be made available to third person or competing companies without RENERGY permission. The reproduction, distribution and utilization of this document as well as the communication of its contents without explicit authorization is prohibited. Offenders will be held liable and can find up to 50% of the project cost, variations in design can occur to site conditions.